

---

# RED JACKET SUBMERSIBLE TURBINE PUMPS

---

Optimise flow, maximise profits



Building Better Business



# Why Red Jacket?

Red Jacket from Gilbarco Veeder-Root — unsurpassed expertise to help sites optimise fuel flow. The Red Jacket family of Submersible Turbine Pumps ensures that sites can pump fuel quickly, efficiently and safely — whether it's petrol, diesel, aviation fuel, LPG, ethanol / methanol or kerosene — in above ground or underground storage tanks.

## Optimise Flow, Maximise Profits:

- > Industry-leading design enhancements to improve safety
- > Complies with the latest ATEX EN15268 European safety standards
- > New motor range meets or exceeds old motor performance with up to 5% increased flow
- > Even longer motor life
- > Easy and safe to install and service
- > Quick Set adjustable column pipe option
- > Optimise station design
- > Eliminate vapour lock
- > Enhance your customers' fuelling experience
- > Integrate with TLS-Monitoring Systems for automatic line testing and dry run / water protection



# Technical Specifications

## Red Jacket 4" Submersible Turbine Pumps

Horse Power	0.75	1.5	1.5 x 4	2.0
<b>Standard Versions</b>				
Quick set models	P75U17-3 RJ1/2/3	P150U17-3 RJ1/2/3	X4P150U17 RJ1/2/3	P200U17-4 RJ1/2/3
Part numbers	410140-074/5/6	410141-076/7/8	410143-071/2/3	410142-051/2/3
Fixed length models	P75U17-3 RJ	P150U17-3 RJ	X4P150U17 RJ	P200U17-4 RJ
Part numbers	410177-014	410177-011	410177-012	410177-013
Fuel compatibility	Diesel, 100% Petroleum, 80% Petroleum with 20% Ethanol, Methanol, TAME, ETBE, or MTBE			
<b>AG Versions (Hi-alcohol)</b>				
Quick set models	AGP75U17-3 RJ1/2/3	AGP150U17-3 RJ1/2/3	X4AGP150U17 RJ1/2/3	AGP200U17-4 RJ1/2/3
Part numbers	410140-080/1/2	410141-082/3/4	410143-077/8/9	410142-057/8/9
Fuel compatibility	Ethanol up to 90% (E85), Methanol up to 100%, MTBE, ETBE, or TAME concentrations up to 20%			
<b>Performance Specifications</b>				
Flow rate @ 0.7 Bar in petrol	200 LPM	300 LPM	220 LPM	330 LPM
Static pressure in petroleum	2.4 Bar	2.5 Bar	2.8 Bar	3.1 Bar
<b>Installation Requirements</b>				
Electrical supply	3-phase, 50Hz, 380 – 415 Volts AC			
Required NPSH (Net Positive Suction Head)	100 mm above pump inlet			
<b>Certification</b>				
ATEX approval	II 1/2 G EN15268 IIA T3 DEMKO 12 ATEX 1247797 X			
Special conditions for safe use	See Manual 577014-049 for details of installation, operation and maintenance requirements			
<b>Field replacements for older STP models</b>				
New Replacement UMPs are available for old 3-phase and Single phase models - please refer to the current Red Jacket EU Price List				



# Key Benefits

## The new benchmark in STP safety

Red Jacket's new ATEX approved submersible turbine pumps incorporate unique design enhancements to create multiple levels of safety protection allowing the Red Jacket Submersible Turbine Pumps to operate safely even in high risk conditions – when a fuel tank runs low and contains potentially explosive vapours.

### > Advanced motor safety

Designed with increased electrical insulation and clearances between moving components to prevent sparks. High temperature index rating materials (T3) used to prevent ignition of fuel vapours if the motor / pump runs dry. Flameproof build with the structural strength and integrity to withstand and contain an explosion.

### > Advanced pump safety

Developed with anti-static material to prevent build-up of static electricity. Designed with high temperature index rating materials to reduce wear if pump runs dry.

### > Advanced packer manifold safety

Electrical design provides secondary vapour barrier to prevent fuel vapours entering the manifold from the tank. In the event of improper power shut off during servicing, it also prevents exposure of electrical sparks to fuel vapour or liquid.

## Improved performance and reliability

Experience the industry's most advanced motor. The STP motor is the heart of the pressure system, controlling the flow of fuel through every pipe, to every dispenser and to every nozzle. Red Jacket's new, improved motor delivers higher efficiency fuel flow, allowing Red Jacket to continue to offer you the most advanced STPs.

### > Increased flow

The new design allows more fluid to pass between the motor and pump shell to reduce flow resistance, meaning flow rates increase by up to 5% vs. old models. This has been achieved without increasing the outer shell diameter to prevent future servicing issues as the riser clearance is maintained.

### > Even more reliability

The lower maximum operating temperature together with improved insulation means the motor is more reliable as well as being safer. New bearing design with increased surface area contributes to quieter running and less wear, extending motor life.

## Red Jacket is easier and safer to install and service

The advanced Packer Manifold design features are retained for all new STP models, offering unsurpassed ease of safe installation and maintenance to benefit both site operators and their forecourt contractors.

### > Installation advantages

The Quick Set adjustable column pipe option makes it easier to install the STP on site, as the length can be adjusted for optimum operation. The integrated Contractors Box and Capacitor Housing removes the need for a separate yoke / junction box to save installation time, and the unique versatile swivel siphon cartridge simplifies difficult connections.

### > Maintenance safety focus

During the removal process the electrical connection is automatically broken before the fuel seal is broken, and automatically reconnects when re-fitted. Also, fuel in the manifold and non-isolated piping drains safely back to the tank, preventing spills and minimising service costs. Reduced lifting force is required to remove the extractable, as die springs automatically break the seal, saving up to hundreds of pounds of lifting force.

# Why Gilbarco Veeder-Root?

Our experience and expertise in the fuelling industry means we understand your business and environmental needs better than anybody. Gilbarco Veeder-Root stands for quality, innovation and proven performance.

2013 saw the introduction of a completely new range of 4" Submersible Turbine Pumps designed to pump fuel quickly, efficiently and safely whilst maximising the uptime of your forecourt.

We use our long standing knowledge and experience of pressure systems to create industry leading fuel delivery solutions that help with building better business.

The latest Red Jacket model range sets a new standard for quality, safety and reliability from the world leaders in pressure technology.

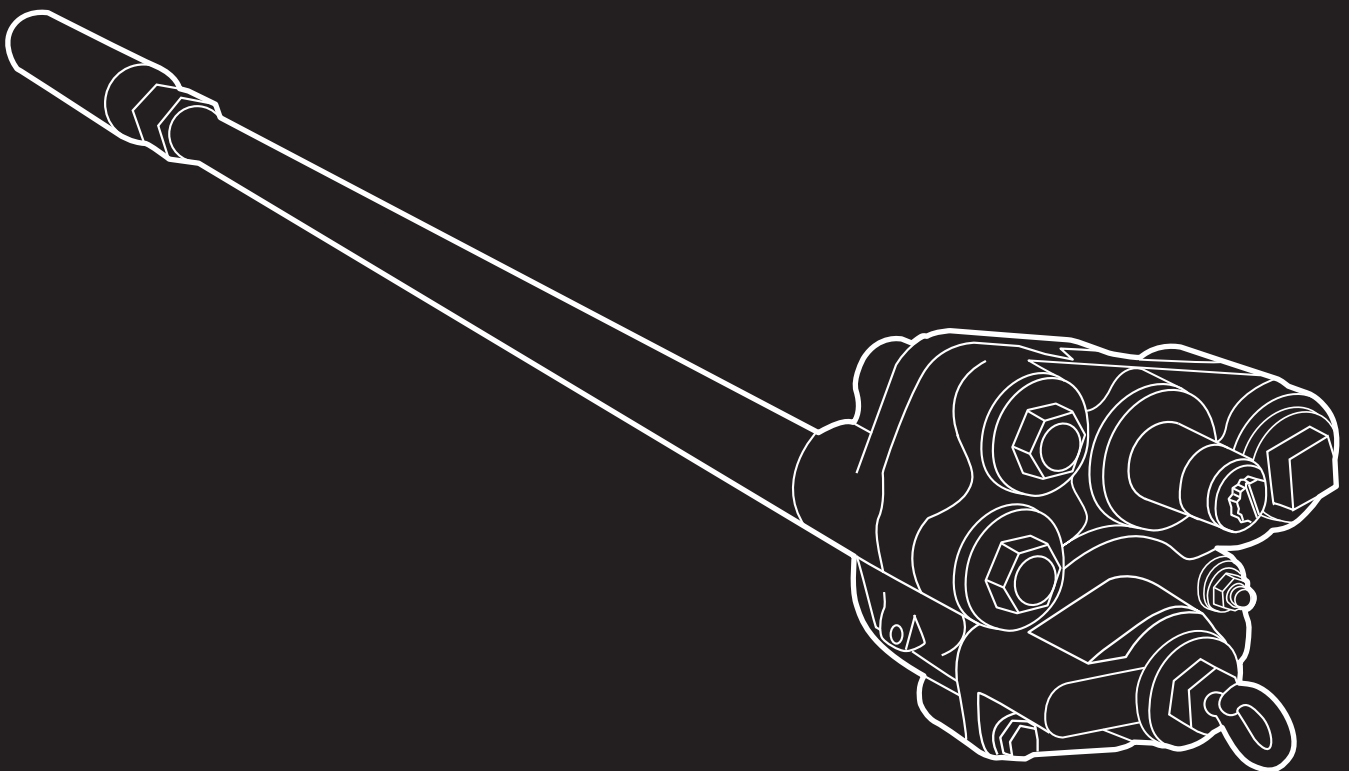

# Gilbarco Veeder-Root Solutions

With a universal range, global reach, deep-rooted expertise and superior customer service, Gilbarco Veeder-Root is committed to building better business for its customers.

## Wetstock Management

**Improve performance, uptime and security**

Our comprehensive range of compliant and reliable Wetstock Management solutions offer you advanced engineering and a responsive service. Scalable and customisable, our tools provide control, security and data across networks of all sizes anywhere in the world.

Ultimately, our solutions enable you to stay compliant and in control.

Our range includes:

- > Automatic Tank Gauging
- > Submersible Turbine Pumps
- > Remote Monitoring - Insite360

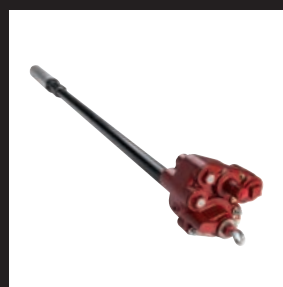

## Business Support

**Protect assets and drive operational efficiency**

Our Business Support solutions minimise downtime and disruption by providing the tools, services and technology necessary for our customers to get more from their businesses.

With an extensive reach throughout Europe, you can be assured that no matter where your business takes you, our comprehensive range of services will always be available.

## Pumps & Dispensers

**Robust, reliable, accurate and secure technology**

Our Pumps & Dispensers feature flexible, innovative and upgradable technology. They not only grow with your business, but also improve the forecourt experience for your end-users.

By focusing on the unique requirements of our customers, we deliver high quality and reliable solutions that are designed to support better business now and in the future.

## Retail Solutions

**Maximise profitability and minimise overheads**

Our leading Point of Sale (POS), Head Office Systems (HOS), Back Office Systems (BOS) and forecourt controllers create new business at the pump and enable deeper insights into stock, logistics and security.

Working alongside our wide range of products and services, our Retail Solutions are designed to work for you.